

Master Fee Schedule Amendments: New City Facilities

**South San Francisco City Council Meeting
June 14, 2023**

Master Fee Schedule Amendment

- New Library | Parks and Recreation Center
- Orange Memorial Park Sports Complex
- Police Department Community Room
- Oyster Point Park

Master Fee Schedule Amendment

- May 16: Approved by Parks and Recreation Commission
- May 31: Reviewed by City Council Budget Committee

Orange Memorial Park Sports Complex

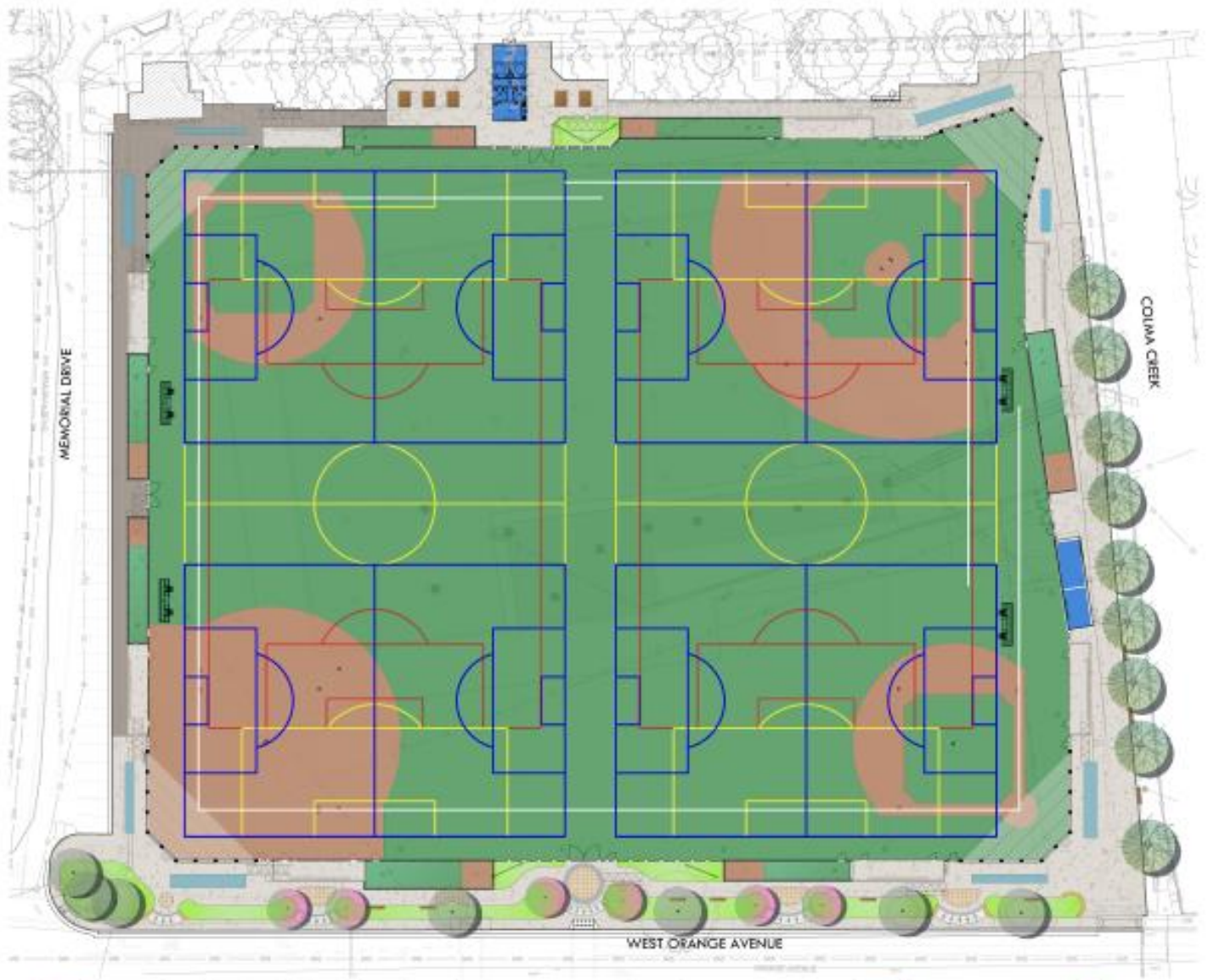

- | | | | | | | | | | |
|---|--|---|-----------------|---|-------------------------|---|-----------------------|---|-----------------------|
|  | Green Synthetic Turf With Shock Pad and Olive Infill |  | Asphalt Paving |  | Colored Concrete Paving |  | 18" Concrete Seatwall |  | Proposed Accent Trees |
|  | Brown Synthetic Turf With Shock Pad and Olive Infill |  | Concrete Paving |  | Colored Concrete Paving |  | Planting Area |  | Existing Trees |

Orange Memorial Park Sports Complex

| Orange Memorial Park Sports Complex | | Resident |
|---|-----------------|----------|
| All Weather Soccer Fields | | |
| Non-resident rates are an additional \$40 per hour | | |
| Full Soccer Field | Per hour | \$ 80 |
| Half Size Soccer Field | Per hour | \$ 40 |
| All Weather Baseball/Softball Fields | | |
| Non-resident rates are an additional \$40 per hour | | |
| Full Size (Large diamond dimensions) | Per hour | \$ 80 |
| Youth Size (Small diamond dimensions) | Per hour | \$ 40 |
| Bullpen | Per hour | \$ 25 |
| Batting Cages | Per hour | \$ 25 |
| Other Add-Ons | | |
| Non-resident rates are an additional \$40 per hour | | |
| Field Attendant | Per hour | \$ 30 |
| Commercial / For Profit Group (add-on) | Per Hour add-on | \$ 40 |

Library | Parks and Recreation Center



Library | Parks and Recreation Center

| Library Parks and Recreation Community Civic Campus | | Resident |
|---|---|----------|
| Facility Rentals | | |
| Non-resident rates are an additional \$40 per hour | | |
| Non-profit rates are \$15 less per hour | | |
| Banquet Hall | Per Hour; 5-hr minimum (Fri-Sun) 2-hr minimum (Mon-Thu) | \$ 275 |
| Social Hall | Per Hour; 5-hr minimum (Fri-Sun) 2-hr minimum (Mon-Thu) | \$ 215 |
| Banquet Hall & Social Hall | Per Hour; 5-hr minimum (Fri-Sun) 2-hr minimum (Mon-Thu) | \$ 400 |
| Full Kitchen | Per Hour; 5-hr minimum (Fri-Sun) 2-hr minimum (Mon-Thu) | \$ 125 |
| Full Kitchen with hall rental | Flat Rate | \$ 250 |
| Kitchen A | Per Hour; 5-hr minimum (Fri-Sun) 2-hr minimum (Mon-Thu) | \$ 75 |

| | | |
|--|---|--------|
| Kitchen A with hall rental | Flat Rate | \$ 150 |
| Kitchen B | Per Hour; 5-hr minimum (Fri-Sun) 2-hr minimum (Mon-Thu) | \$ 50 |
| Kitchen B with hall rental | Flat Rate | \$ 100 |
| Council Chambers | Per Hour | \$ 120 |
| Atrium | Per Hour | \$ 50 |
| Patio | Per Hour | \$ 100 |
| Patio with hall rental or Council Chambers | Flat Rate | \$ 100 |
| Dance & Fitness Studio A | Per Hour | \$ 105 |
| Dance & Fitness Studio B | Per Hour | \$ 95 |
| Music Room (A, B, or C) | Per Hour | \$ 50 |
| Childrens Classroom | Per Hour | \$ 95 |
| Exercise Studio | Per Hour | \$ 105 |
| Gallery Room | Per Hour | \$ 95 |
| Creator's Studio | Per hour | \$ 105 |

Police Department Community Room: \$120 / hr. (resident)

Oyster Point Park



Oyster Point Park

| Picnic Rentals | | Resident |
|---|----------|----------|
| Oyster Point Marina | | |
| Non-resident rates are an additional \$15 per hour | | |
| Area #1 (6 tables) | Per Hour | \$109.20 |
| Area #2 (3 tables, no BBQ) | Per Hour | \$25 |
| Area #3 (3 tables, no BBQ) | Per Hour | \$25 |
| Area #2 (3 tables) | Per Hour | \$54.60 |
| Area #3 (3 tables) | Per Hour | \$54.60 |