



New Park at Linden Avenue & Pine Avenue Art Component Artist Finalist

December 10, 2025

City Council

New Park at Linden & Pine - Overview

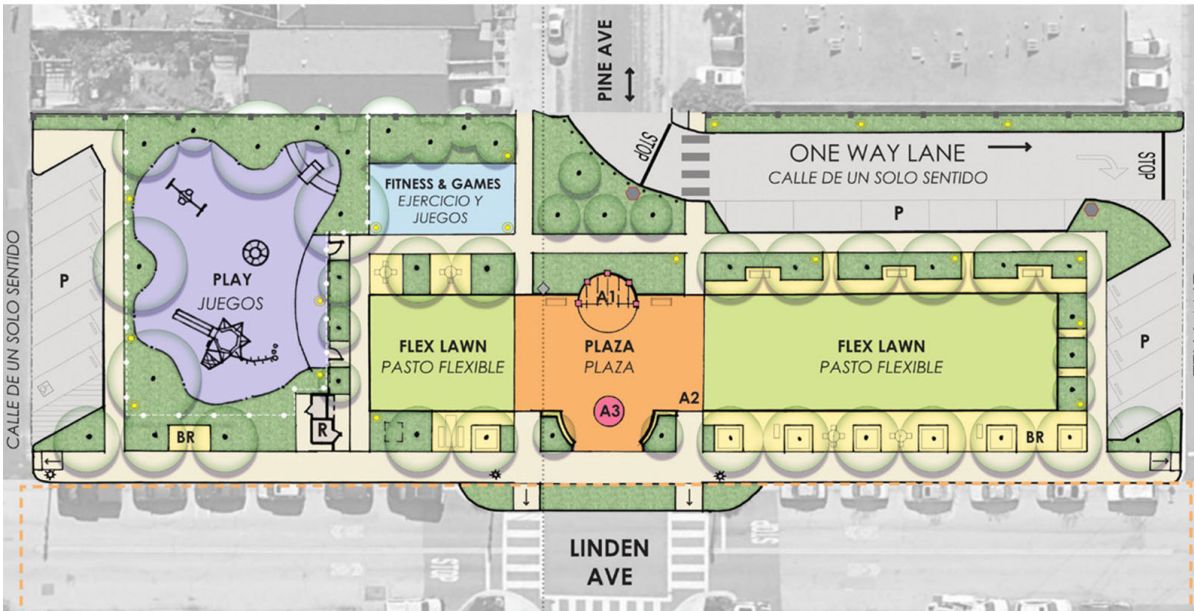

Identified Art Priorities:

- Interactive Art
- Murals
- Entry/Identity Art

Community Outreach to Inform the Design :

Visioning Phase:

- Open House (4/13/2024)
- Visioning Pop-up (5/1/2024)
- National Night Out Tabling (8/16/2024)

Design Alternative Phase:

- Open House 2 (8/24/2024)
- SSF Youth Commission (9/9/2024)
- Concert in the Park (9/21/2024)
- Merchant's Round Table (9/27/2024)
- Centennial Way Park South Grand Opening (9/29/2024)
- Morelos Hall (9/9/2024)
- Online Survey

Visioning Phase:

- Open House 3 (3/1/2025)
- Parks & Recreation Commission (3/18/2025)
- City Council Presentation (5/14/2025)

New Park at Linden & Pine - Overview

The project includes three distinct but coordinated mosaic art components designed to work in harmony:

1. **Mosaic Columns at Plaza**
2. **Mosaic Inlays at Plaza**
3. **Playground Mosaic Sculpture.**

The goal is for a single artist or artist team to develop all three to create a cohesive visual and conceptual language throughout the site.

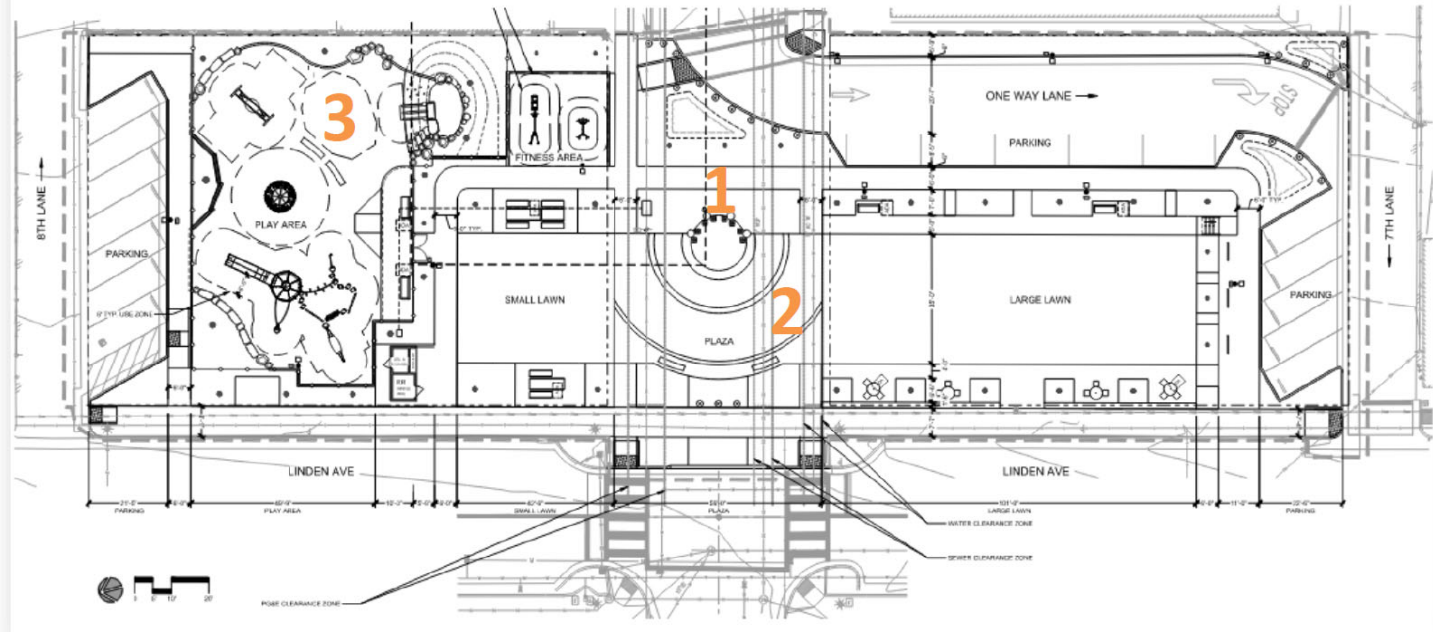

New Park at Linden & Pine – Artist Selection Process

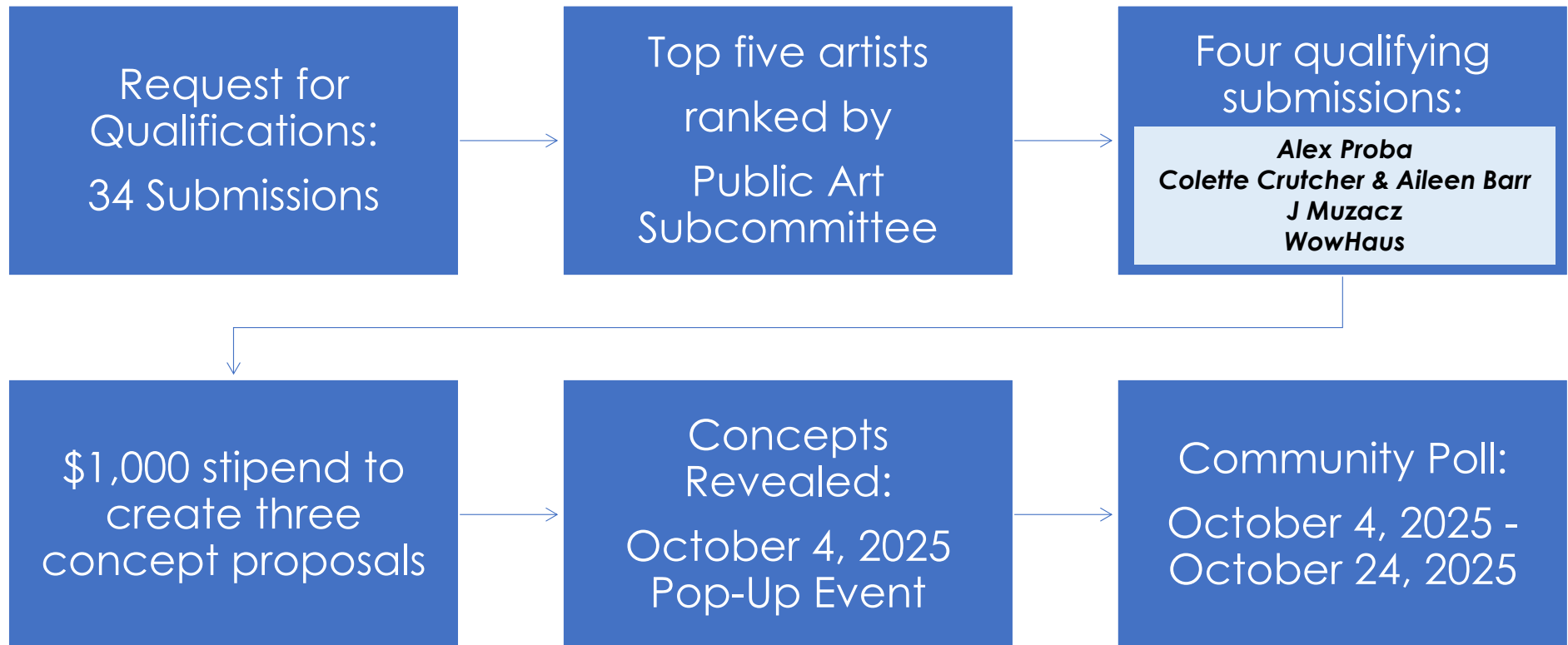

New Park at Linden & Pine – Artist Selection Criteria

- Artistic Excellence and Originality (35 points)
- Relevant Experience (20 points)
- Technical Capability (15 points)
- Community Engagement Approach (15 points)
- Professionalism & Collaboration (10 points)
- Local/Regional Connection (5 points)



Public Art Subcommittee Rankings

New Park at Linden & Pine - Artist Selection Update

Artist/Concept	Total Points
J Muzacz	15.0
Alexandra Proba	11.0
WowHaus	8.0
Colette Crutcher & Aileen Barr	7.0

1st Choice = 4 points
 2nd Choice = 3 points
 3rd Choice = 2 points
 4th Choice = 1 point

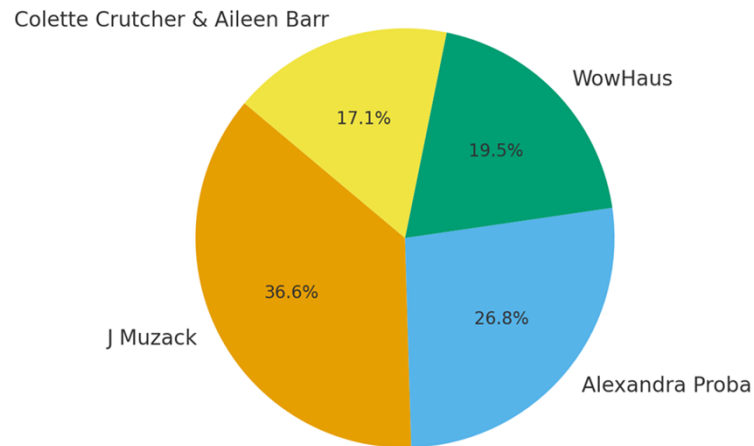

Community Engagement

New Park at Linden & Pine - Artist Selection Update

Pop-Up Event
Saturday, October 4, 2025



New Park at Linden & Pine - Artist Selection Update

Community Poll Results



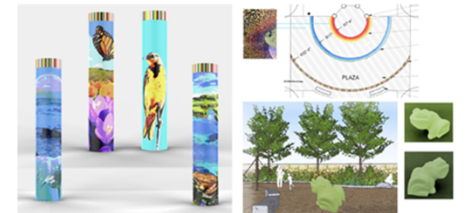
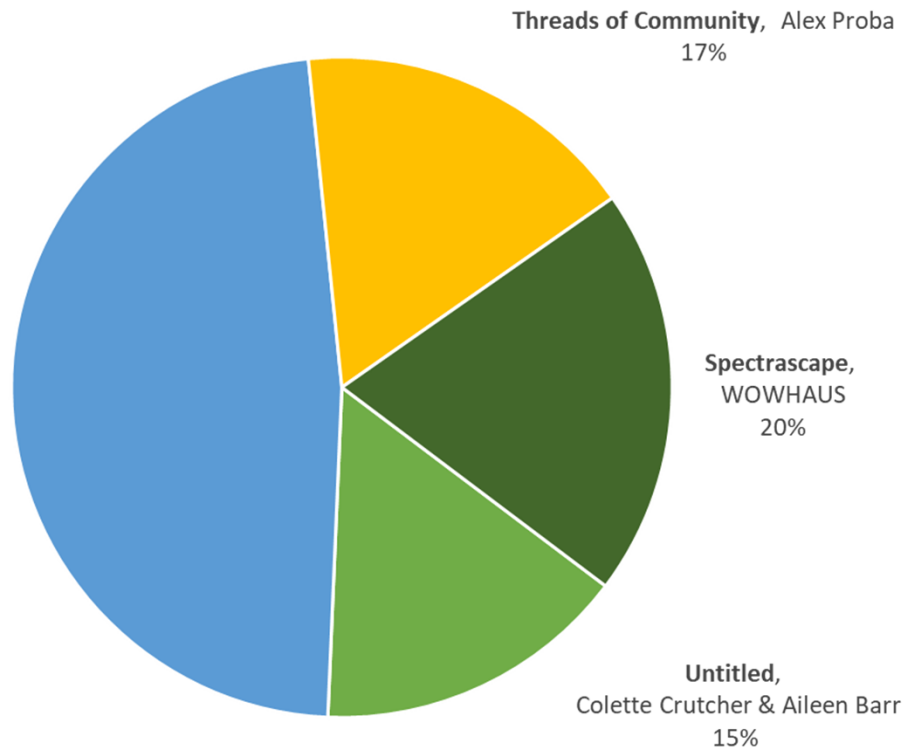



Which is your preferred concept? (Select one)



New Park at Linden & Pine - Artist Selection Update

Community Poll Results

Which of the following applies to you?

		Percent	Count
I live in South San Francisco / <i>Vivo en South San Francisco</i>		76.6%	118
I work in South San Francisco / <i>Trabajo en South San Francisco</i>		23.4%	36
I attend school in South San Francisco / <i>Asisto a la escuela en South San Francisco</i>		11.0%	17
I use South San Francisco parks / <i>Utilizo los parques del South San Francisco</i>		48.1%	74
I visit shops, restaurants, and service businesses/ <i>Visito tiendas, restaurantes y negocios de servicios</i>		50.6%	78
None of the above / <i>Ninguna de las anteriores</i>		1.9%	3

New Park at Linden & Pine - Artist Selection Update

Community Poll Results

What is your age?

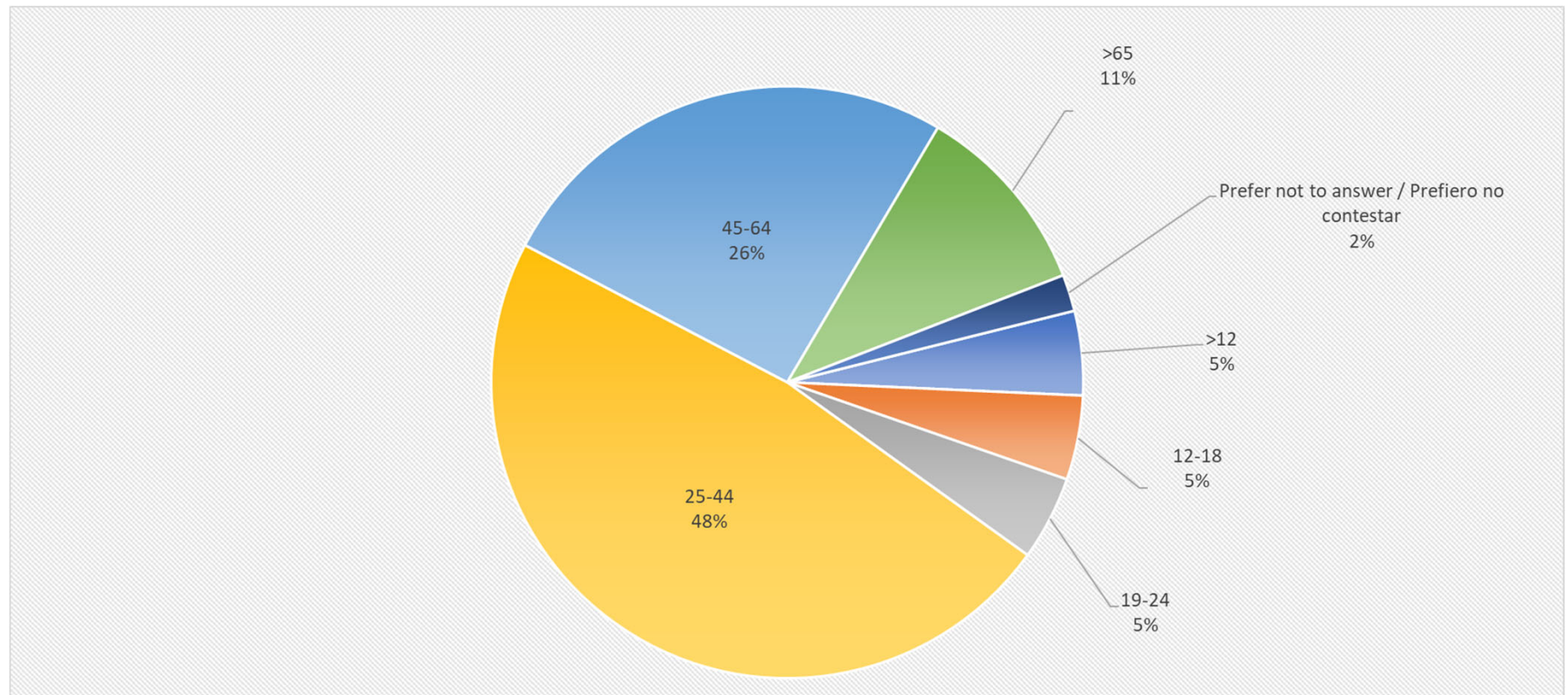



Winning Concept / Recommended Artist

New Park at Linden & Pine - Artist Selection Update

J Muzacz

J Muzacz creates energetic mosaics and vibrant murals using unique community engagement with people of all ages and abilities.

Inspired by cultural diversity, humanitarian leaders, and the natural world, Muzacz bestows reverence on every project by creating site-specific artwork that uniquely speaks to the area's history and culture, fostering individual empowerment and collective celebration.

Originally from Houston and a graduate of the University of Texas in Sociology, Muzacz went on to live and work abroad for the better half of a decade, painting murals all around the world from Japan to New Zealand and beyond. Now based in Austin, Texas, Muzacz has dedicated himself to community building through teaching, mentoring, and creating spaces for artists to connect with community members and uplift each other.

Commissions

- Heart of Texas Collaborative Mosaic Mural at Roanoke Public Library | Roanoke, TX (2025)
- TIAA Parking Garage Collaborative Pixel Mosaic Mural | Frisco, TX (2025)
- Hutchins City Hall Abstract Diptych Mosaic and Fabrication of Two Pixel Mosaic Murals | Hutchins, TX (2025)

Statement of interest

Creating artwork at the intersection of antiquity and modern technology, my work blends contemporary digital design with the ancient handmade process of mosaics. This opportunity at the new Linden and Pine Park feels like a natural extension of my practice, rooted in history, culture, environment, and play—values central to my work.

Website: www.jmuzacz.com

New Park at Linden & Pine - Artist Selection Update



New Park at Linden & Pine - Artist Selection Update

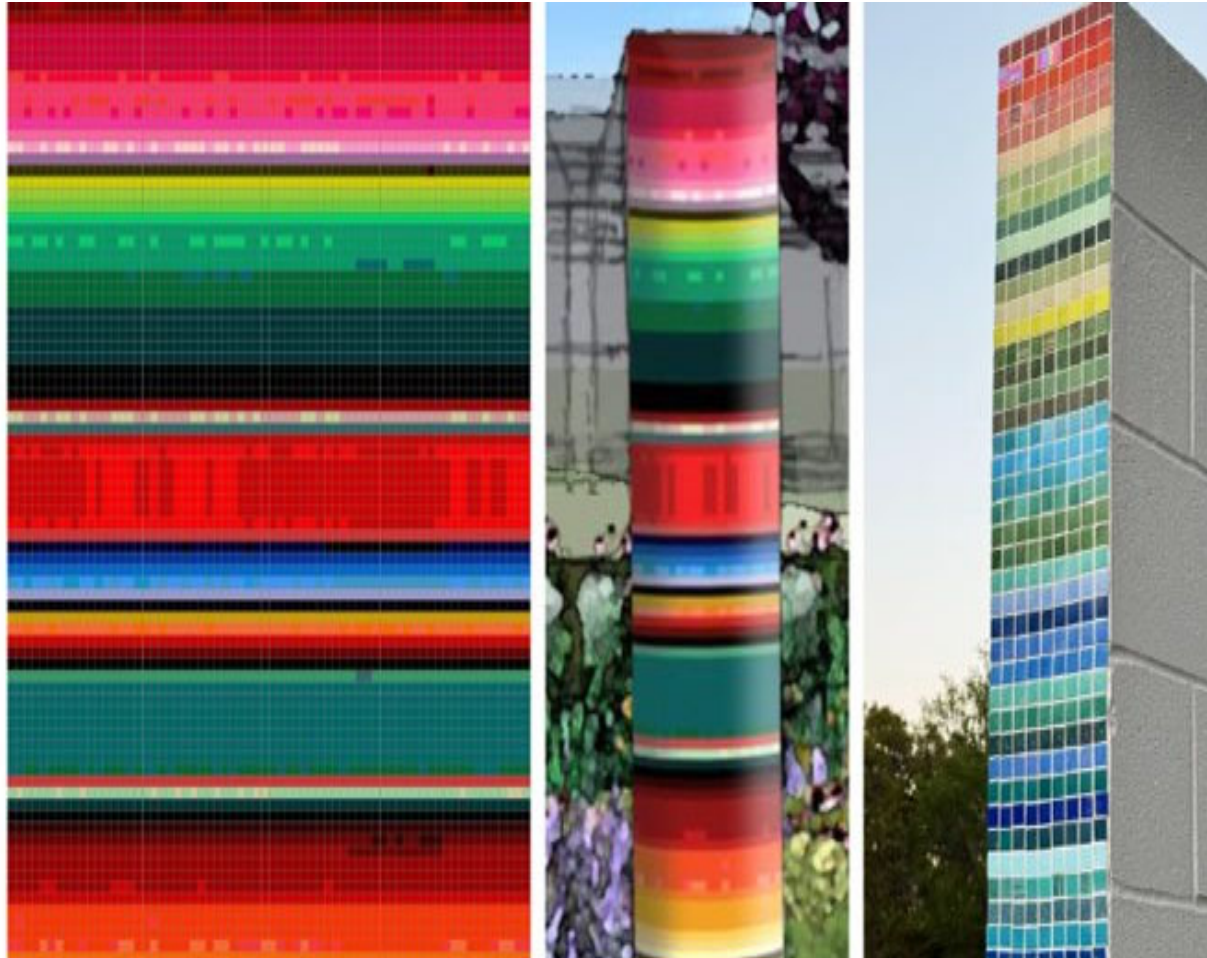

New Park at Linden & Pine - Artist Selection Update



New Park at Linden & Pine - Artist Selection Update



New Park at Linden & Pine - Artist Selection Update



Community workday from project at Ciquio Vasquez Park

New Park at Linden & Pine - Artist Selection Update

Next Steps

- Notify Artist & Contract Signing
- Work with Artist on Refining Design
- Community Workshop
- Fabrication & Installation
- New Park at Linden Avenue and Pine Avenue Opening



THANK YOU

New Park at Linden Avenue & Pine Avenue
Art Component Artist Finalist
City of South San Francisco